

SLAM

SOUTHWICK LANDSCAPE ARCHITECTURAL MEMO

southwick
LA

Designing the Southwest

Volume 1, Issue 3, September 2007

FALL IS COMING

BY: MATT DURHAM

It's finally starting to cool off and summer blooms lead to fall colors. Fall brings shorter days and cooler temperatures, which for some plants, means it time to prepare for winter while others are just starting to bloom. Chlorophyll production, which gives plant leaves a green color, begins to slow revealing the reds and yellows from sugar production. Trees like the Chinese Pistache (*Pistacia chinensis*) and Raywood Ash (*Fraxinus oxycarpa 'Raywood'*) are two great examples of fall color in the valley. While some plants are coloring landscapes with their foliage others take advantage of cooler temperatures by blooming. Trees and shrubs such as Chitalpa (*Chitalpa tashkentensis*), Mexican Bird of Paradise (*Caesalpinia mexicana*) and Autumn Sage (*Salvia greggii*) all continue to flower from summer through fall while others like Regal Mist (*Muhlenbergia capillaris*) are just beginning their blooms. Check out The Green at the east end of The District in Henderson to see a Southwick designed landscape with these fall displays!

EMPLOYEE SPOTLIGHT

Nicolette has been with SLA for a little over one year so you may have had the pleasure of working with her by now. If not, look forward to it.

She has lived in northern Nevada, Washington state & Texas before finally deciding to make Las Vegas her home for the last five years.



Nicolette moved from Texas to obtain her bachelor's degree in Landscape Architecture from UNLV. Choosing UNLV because it offered a landscape architecture program and most of her family is only seven hours away. She says she chose Landscape Architecture for a variety of reasons. She loved the career options and opportunities it provided. Mostly, she says, she chose her career blindfolded but she loves what she does.

HORSEMAN'S & DOG FANCIER'S PARK

The master plan for Horseman's and Dog Fancier's Park represents a strategic plan to guide the development and growth of the park over the next ten to twenty years. It is a written document that identifies the goals, objectives, principles, guidelines, policies, standards, and strategies for the growth and development of the park. The existing park consists of 37 acres with a dog park on the south, large parking lot in the center and equestrian park on the north. The master plan maintains the existing park uses while updating and adding amenities as well as redesigning the spatial layouts to best meet the user's needs. Dog Fancier's park is the largest in the county. It will have four dog runs, an events area and a water dog play area. Horseman Park has been redesigned to maximize uses and generate revenue. The design focuses on the circulation of people, vehicles and horses to minimize conflicts. This part of the park has two arenas and a barn area. The improvements and modifications made in the master plan will help to increase the use of this well deserving park.

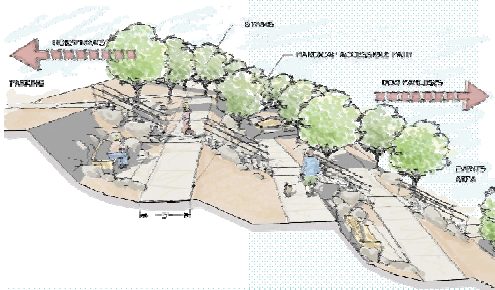

Meandering pathway with lookouts between the two parks.

TAKE A HIKE!

BY: LINDZAY GREEN

We could all use a little more fresh air. So when it's really hot out and you are in desperate need of some family time or even some alone time, take a short drive to Mt Charleston. When it is 100 plus degrees in the Las Vegas valley, it is on average 20 degrees cooler up in beautiful Mt. Charleston. Immersing ourselves in nature often, helps us be more aware of our surrounding environment and how precious it is and it's uniqueness. You might even get a little inspiration!

Mt Charleston is just one area that Clark County has to offer those looking for scenic exploration. There are many hiking opportunities in Mt. Charleston such as Mary Jane Falls, Cathedral Rock or Cold Creek. Make sure and bring plenty of water, and definitely a camera! The early bird gets to stay cool and see what Southern Nevada hiking has to offer. It is not only good for the body and soul, but good for our profession as well. If you are not an early bird, the sunsets are impressive too. It's a wonderful opportunity to watch the sky transform from blue to orange and all colors in between as the sun drops behind the mountain.

PICTURE OF THE MONTH



Big Falls Hike in Mt. Charleston, NV
Taken By: Lindzay Green

DON'T FORGET TO CHANGE YOUR WATER CLOCK!